

Donnie Roberson Site
Martin County, North Carolina

36 Acres

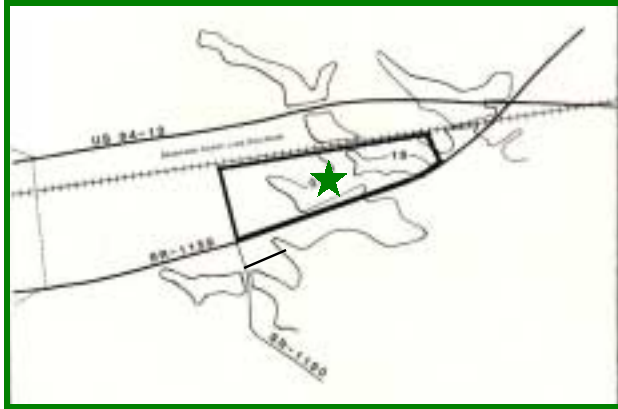

Sales Price	Negotiable
Address	US Hwy 64
City	Robersonville
State	NC
Zip Code	27871
In City Limits	No
Development Stage	Partially
Zoned	Commercial/Office
Present Use	Farmland

Utilities

Electric Service Provider	Edgecombe-Martin EMC	Water Service Provider	Town of Robersonville
Gas Service Provider	NC Natural Gas	Water Main Size	6"
Natural Gas Extension Feasible	Yes	Storage Tanks	Yes
Phone Service Provider	Sprint	Waste Water Treatment Service	Town of Robersonville
		Treatment Type	Anaerobic
		Receiving Line Size	8-24"

Transportation

Four Lane Highway within 20 Miles	Yes
Closest Highway	US Highway 64
Distance to Highway	Located on Highway
Access Road	US Highway 64
Rail Available	Yes
Line Location of Rail	Everetts, NC
Rail Service Company	CSX Transportation
Rail Siding	Yes
Nearest Stream, River, or Creek	Roanoke River

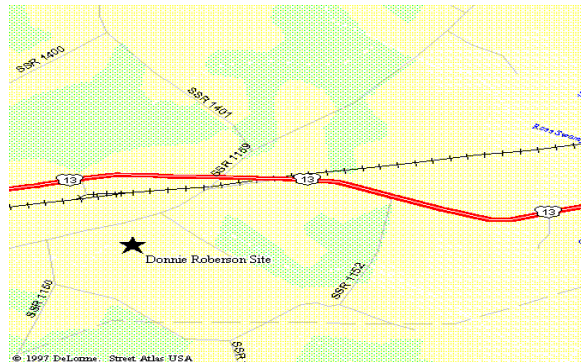

Travel Information to Site

Closest Commercial Airport	Pitt/Greenville Airport	30 Miles
Nearest Interstate Highway	Interstate 95	Approximately 20 minutes
US Highway 64-Bypass is an interstate quality highway.		

For More Information

Martin County Economic Development Corporation
James D. Ward, Executive Director
Post Office Box 310 / 138 West Main Street / Williamston, NC 27892
252-792-2044 - voice / 252-792-0993 - fax / info@martincounty.com